

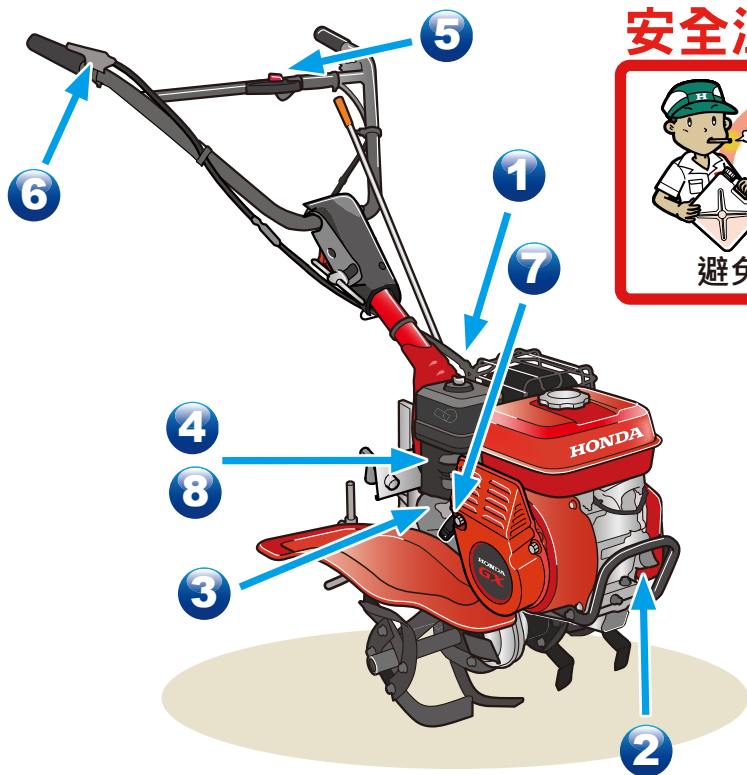

* 操作農耕機之前請詳細閱讀並確實瞭解本使用說明書

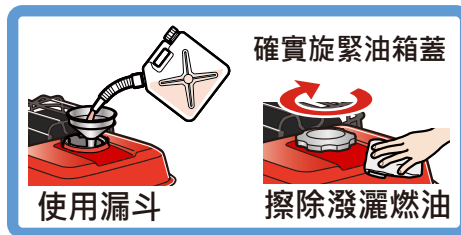

安全注意事項



處理齒具之前

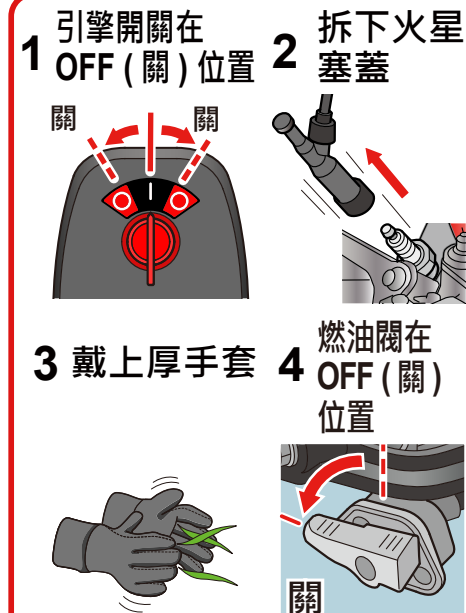

清理耕作區域



避開轉動的齒具

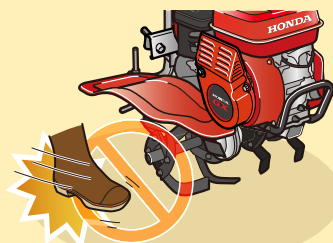

如何起動



1 檔位選擇



空檔位置

2 檢查引擎機油

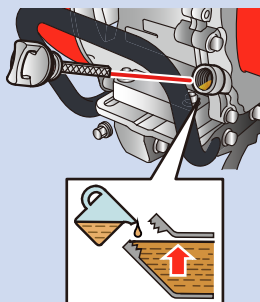

SAE 10W-30
最大 0.58 l

3 燃油閥開啟

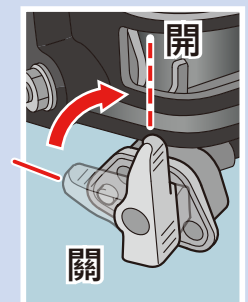

4 阻風門

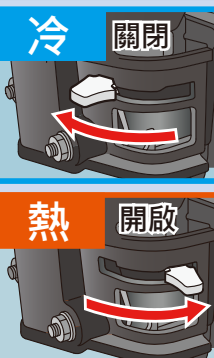

5 引擎開關 開啟



6 油門 控制桿 啟動

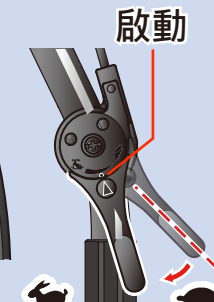

7 啟動

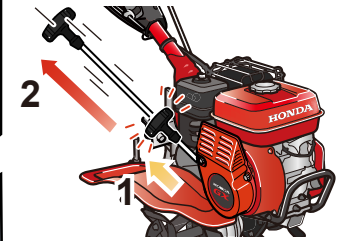
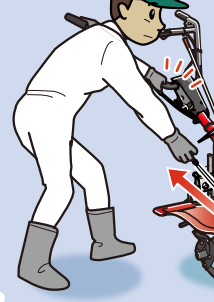

如何熄火

1 N → 6 慢 → 5 關 → 3 關